

evolar

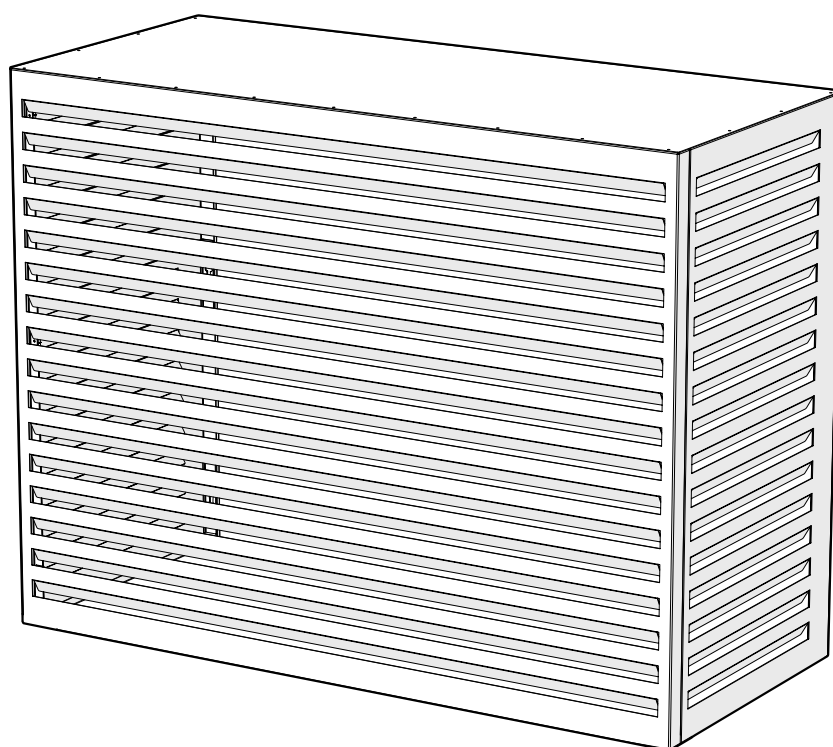

Model numbers: EVO-COVER-XS, EVO-COVER-S, EVO-COVER-M, EVO-COVER-L,
EVO-COVER-XL, EVO COVER-T

EVOLAR COVER

User manual

FOREWORD



Thank you for purchasing the Evolar cover.

This manual contains all the information required for the safe and correct use and installation of the Evolar cover.



Make sure you have read and understood the entire contents of this manual before installing or maintaining the product.

Symbols in this manual

Symbols	Explanation
	Indicates a hazardous situation, that, if not avoided, could result in minor or moderate injury.
	Indicates a situation, that, if not avoided, could result in damage to the product or the environment.

CONTENTS

1	Product	5
1.1	Description	5
1.2	Main parts (included)	5
1.3	Optional parts	6
1.4	Tools required (not included)	6
2	Safety instructions	7
2.1	General safety instructions	7
2.2	Safety warning when installing	7
2.3	Maintenance and cleaning	7
3	Installation	8
3.1	Check the contents of the package	8
3.2	Installation steps	8
4	Optional parts	12
4.1	Feet	12
4.2	Back panel	13
4.3	Bottom panel	13
5	Maintenance	14
6	Disposal	14
7	Warranty	14

1 PRODUCT

1.1 Description

The Evolar cover is a heat pump/air conditioning enclosure. The Evolar cover is intended for use over installed heat pumps/air conditioners.

This manual is suitable for the following Evolar covers:

- Evolar XS (2' x 3' x 1' 4")
- Evolar S (2' 3½" x 3' 7½" x 1' 7⅔")
- Evolar M (2' 7½" x 3' 7½" x 1' 9⅔")
- Evolar L (3' 7½" x 3' 11¼" x 2' 1⅓")
- Evolar XL (4' 3⅓" x 5' 7" x 2' 5½")
- Evolar Tower (5' 3" x 3' 11¼" x 2' 1⅓")

1.2 Main parts (included)

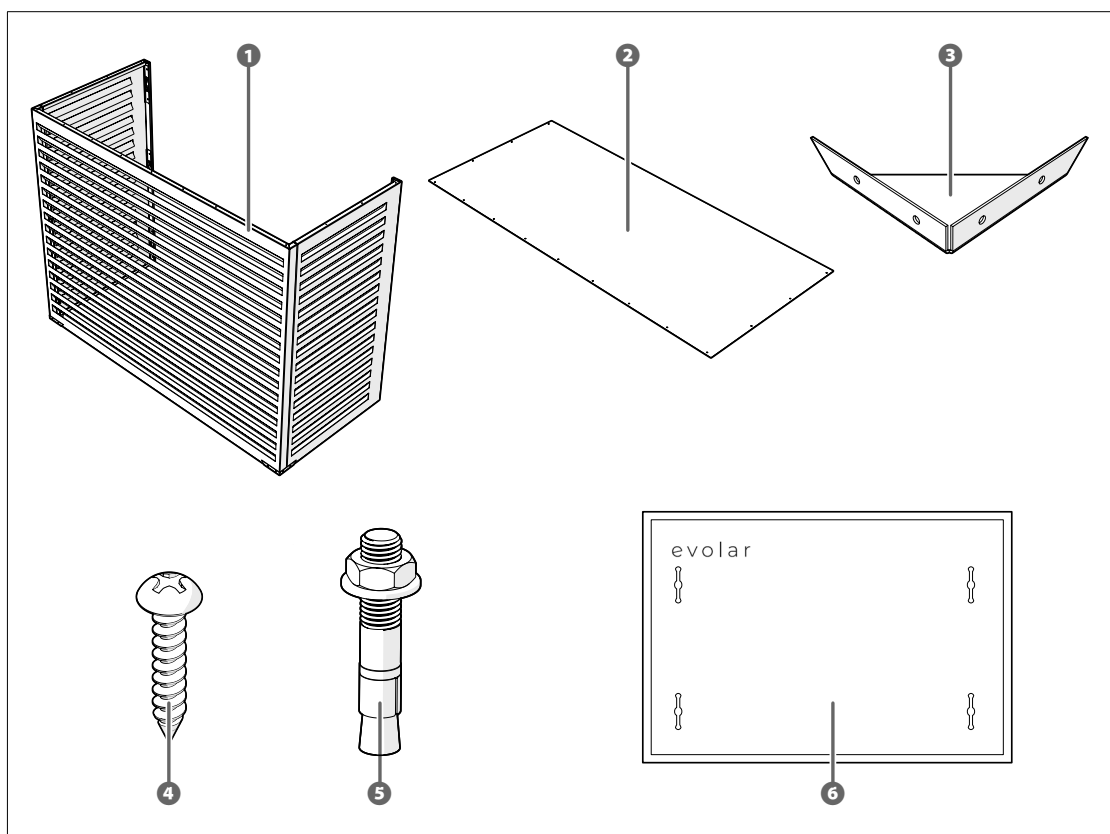

- 1 Enclosure
- 2 Roof panel
- 3 Corner profile 2x
- 4 Screws
- 5 Expansion bolts
- 6 Drilling template

1.3 Optional parts

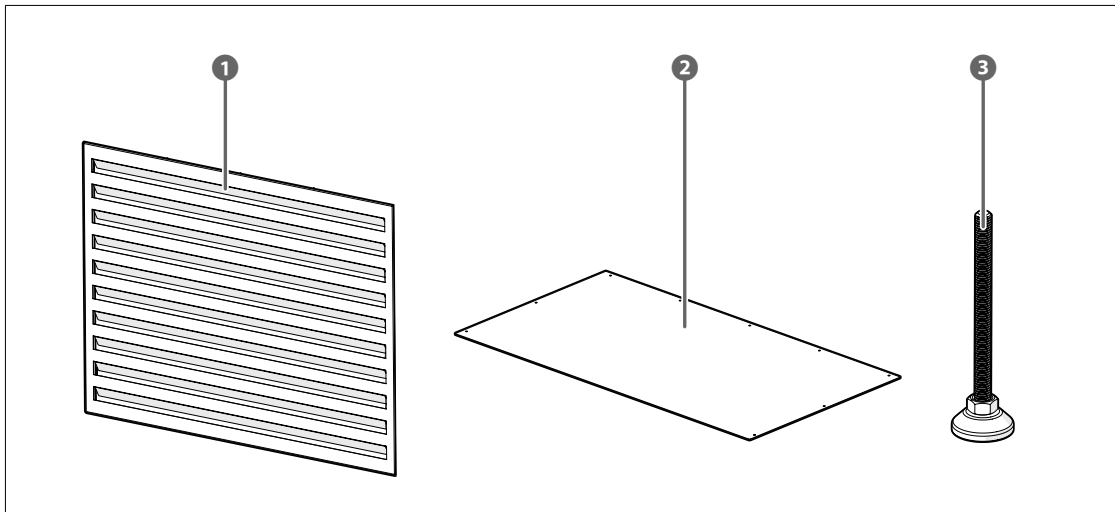

- ① Back panel
- ② Bottom panel
- ③ Feet

1.4 Tools required (not included)

- Screwdriver
- Drill with 8 mm (0.31 inch) and 10 mm (0.39 inch) bits.

2 SAFETY INSTRUCTIONS



Follow the safety instructions in this chapter to prevent hazardous situations.

2.1 General safety instructions

⚠ CAUTION

Risk of injury! The product is designed for use as described in this document. Any usage of the product for purposes other than those specified in this document may lead to hazardous situations. Only use the product and the supplied tools as described in this document.

2.2 Safety warning when installing

NOTICE

Risk of damage to the product! The product cannot withstand impact:

- Do not drop the product and avoid bumping.
- Do not place the product temporarily in a location where it may fall or be knocked over.

2.3 Maintenance and cleaning

NOTICE

Risk of damaging the surface of the product! Harsh chemical cleaning agents, such as ammonia, acid or acetone, can damage the product.

- Only clean the product with a soft, clean, and dry cloth.
- Avoid abrasives that could damage the surface.

3 INSTALLATION

NOTICE

Risk of damage to the product! The product cannot withstand impact:

- Do not drop the product and avoid bumping.
- Do not place the product temporarily in a location where it may fall or be knocked over.

3.1 Check the contents of the package

Check that all parts are present and that they are not damaged. If parts are missing or damaged, contact Evolar.

3.2 Installation steps

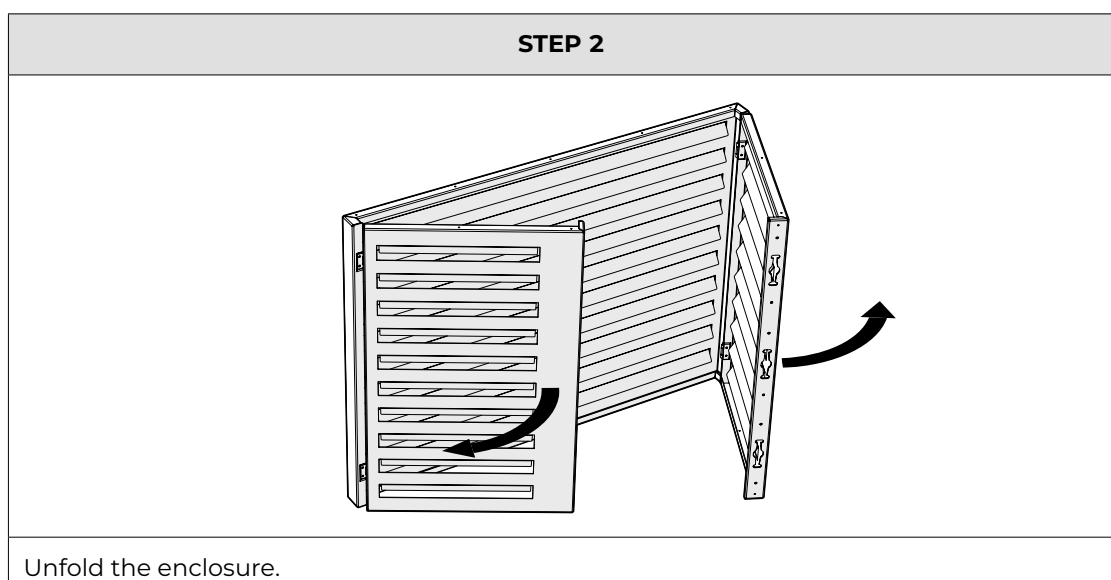
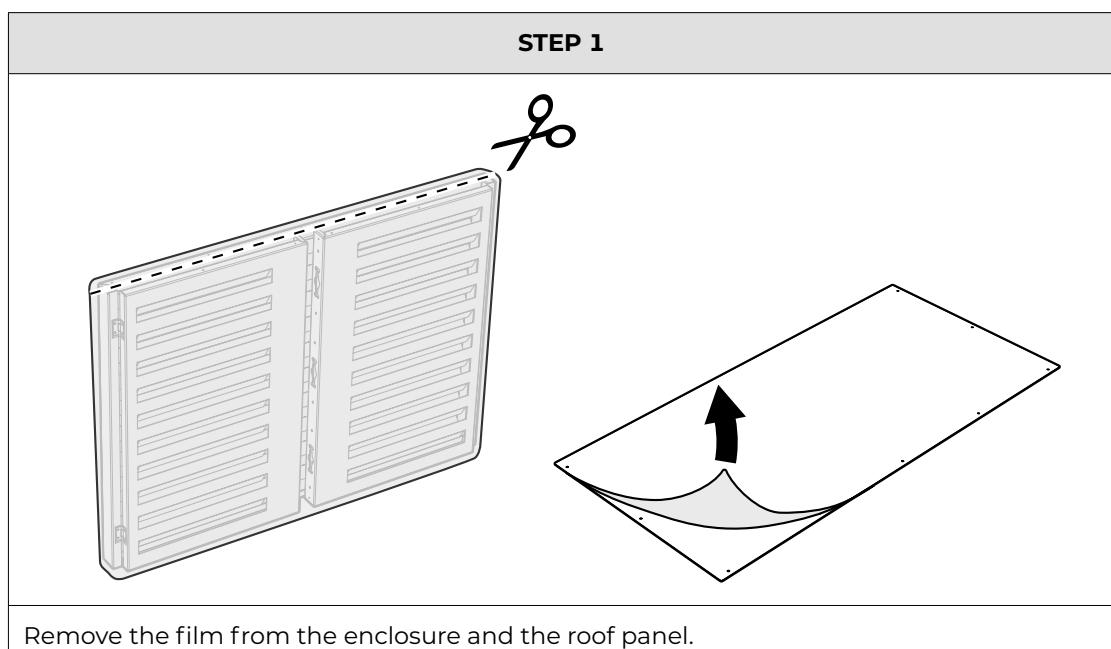

STEP 3

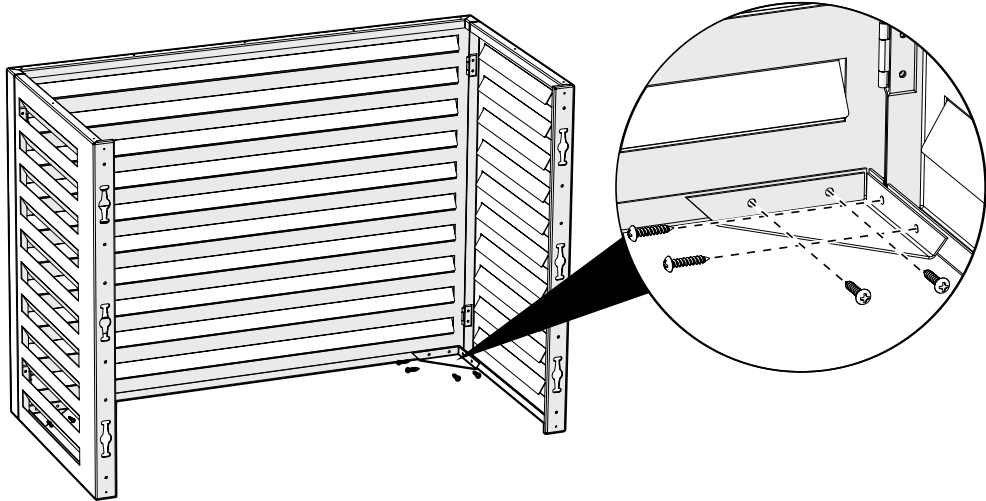

Fasten the corner profiles with the screws.

STEP 4

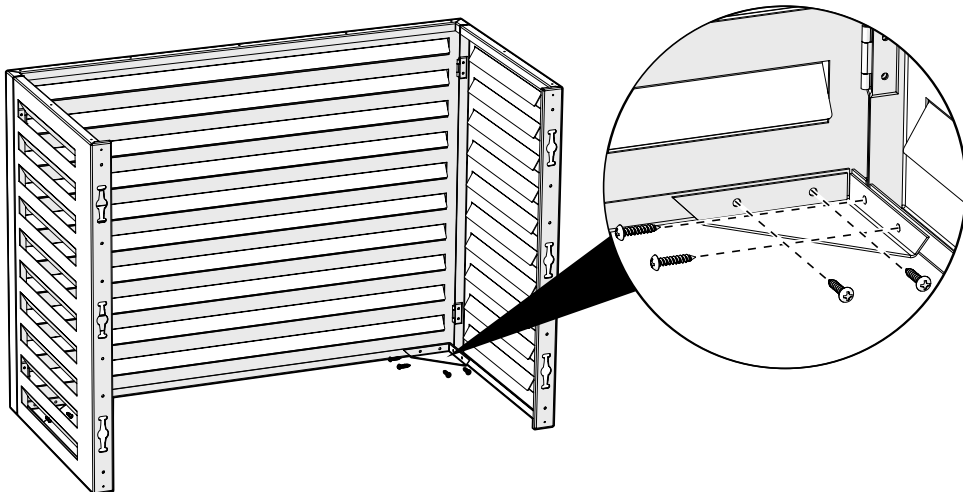

Fasten the roof panel onto the enclosure with the screws.

STEP 5 (OPTIONAL)

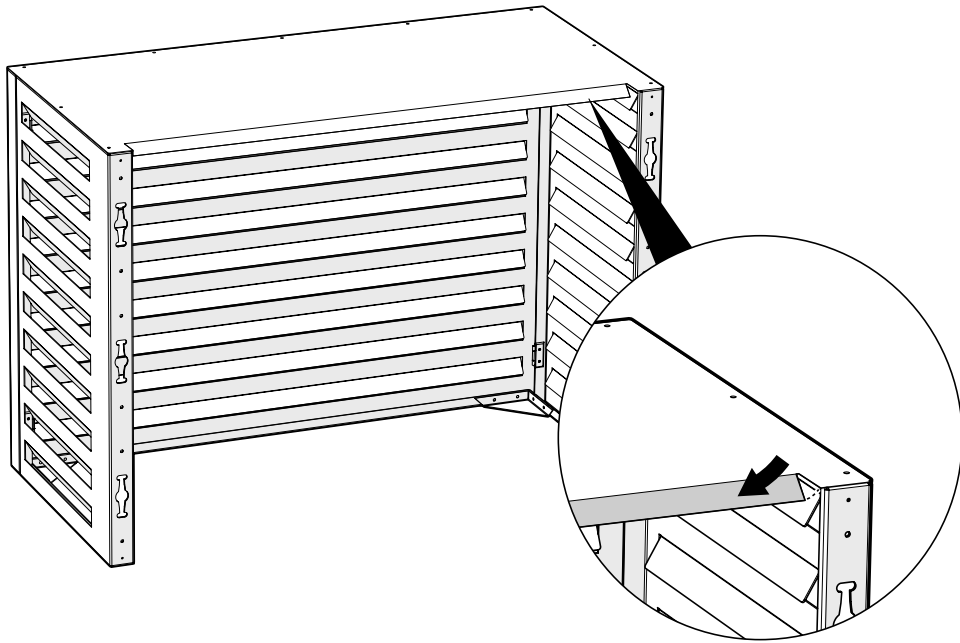

If the heat pump requires more air, fold the folding edge of the top plate downwards.

STEP 6

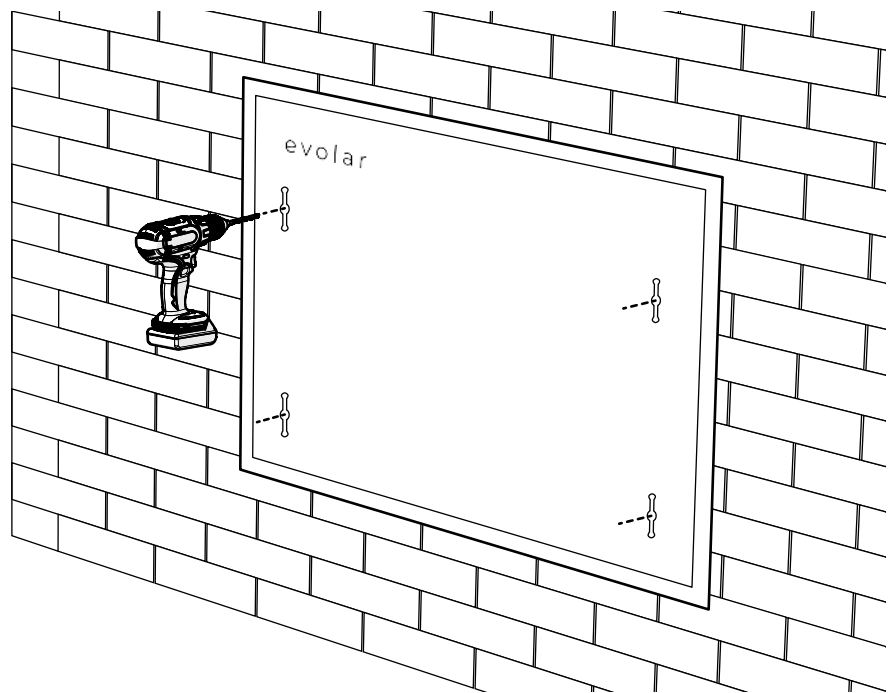

Drill the holes around your installed heat pump.
Drill 10 mm (0.39 inch) holes in the wall using the drilling template supplied.

STEP 7

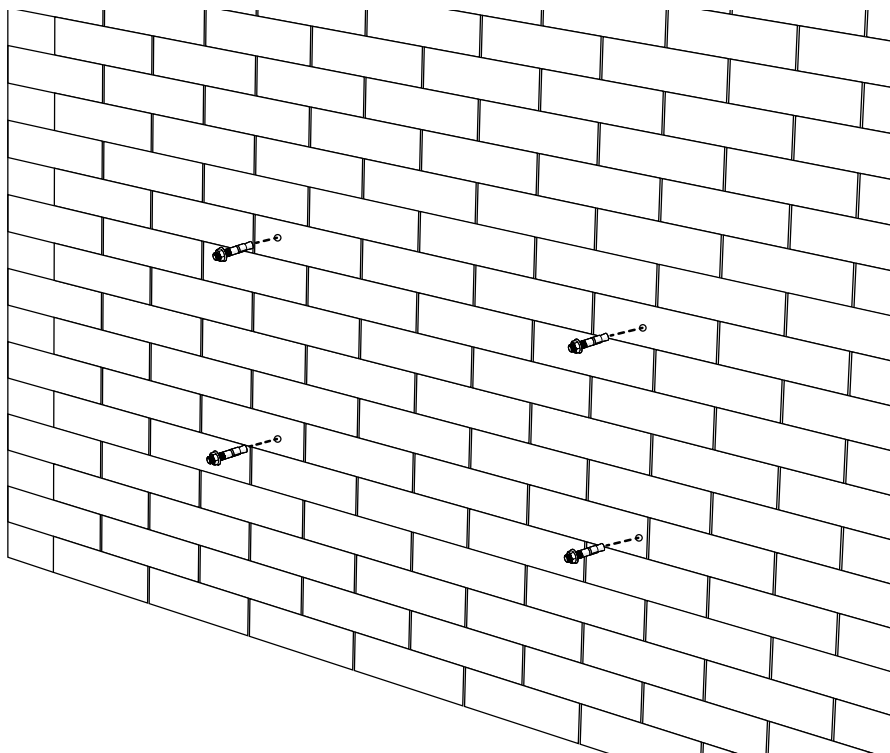

Screw the expansion bolts into the holes.

STEP 8

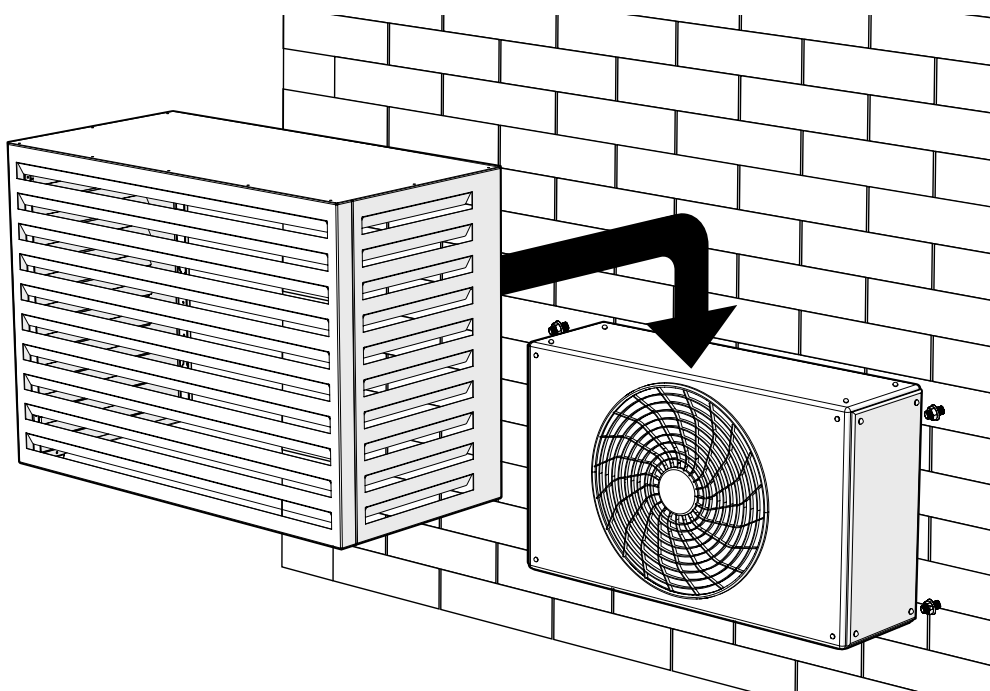

Place the enclosure over the air conditioning/heat pump and/or expansion bolts.

4 OPTIONAL PARTS

4.1 Feet

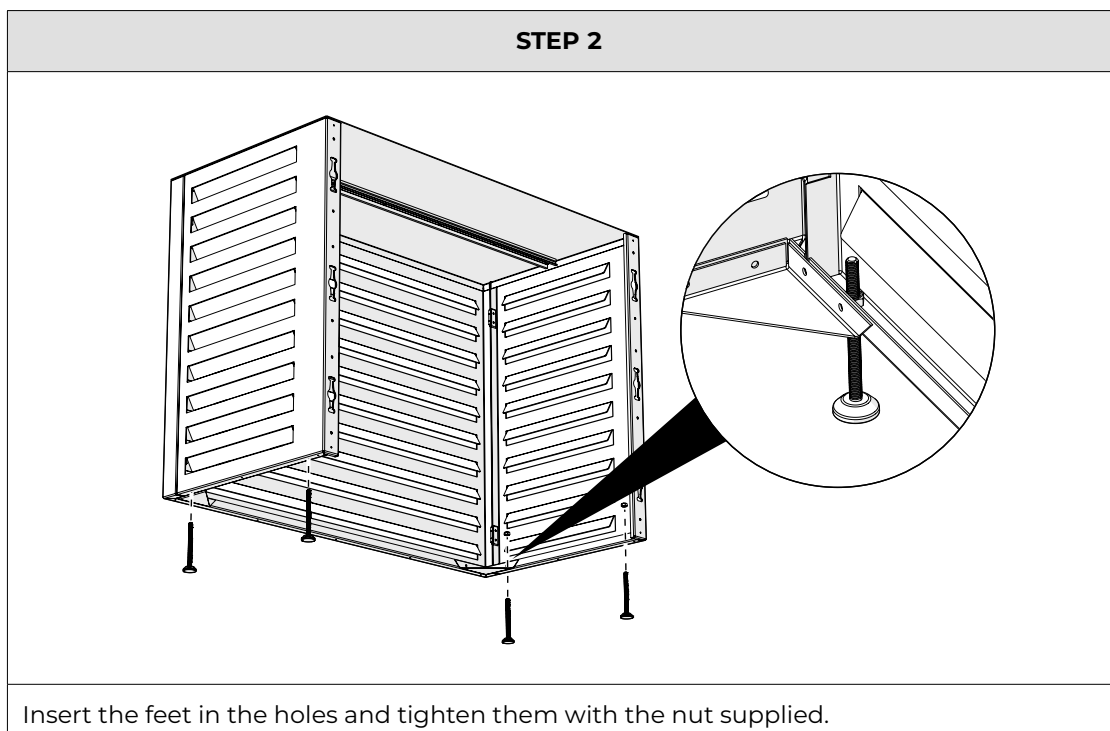
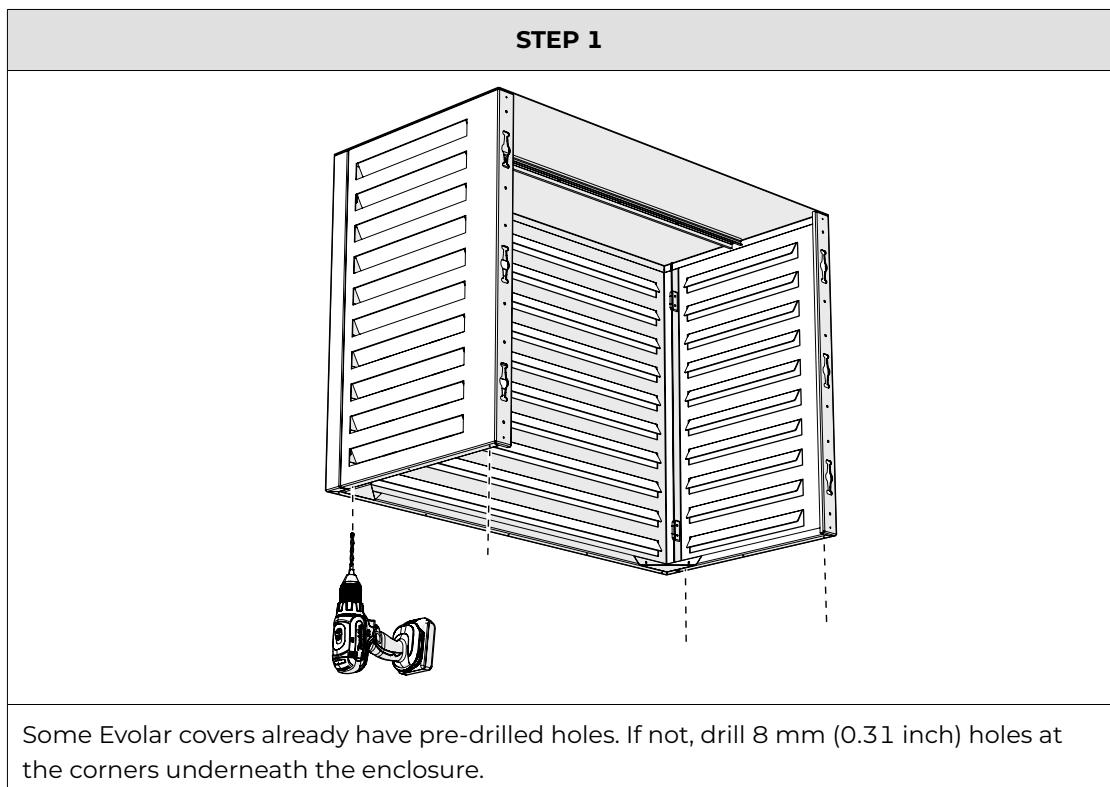

4.2 Back panel

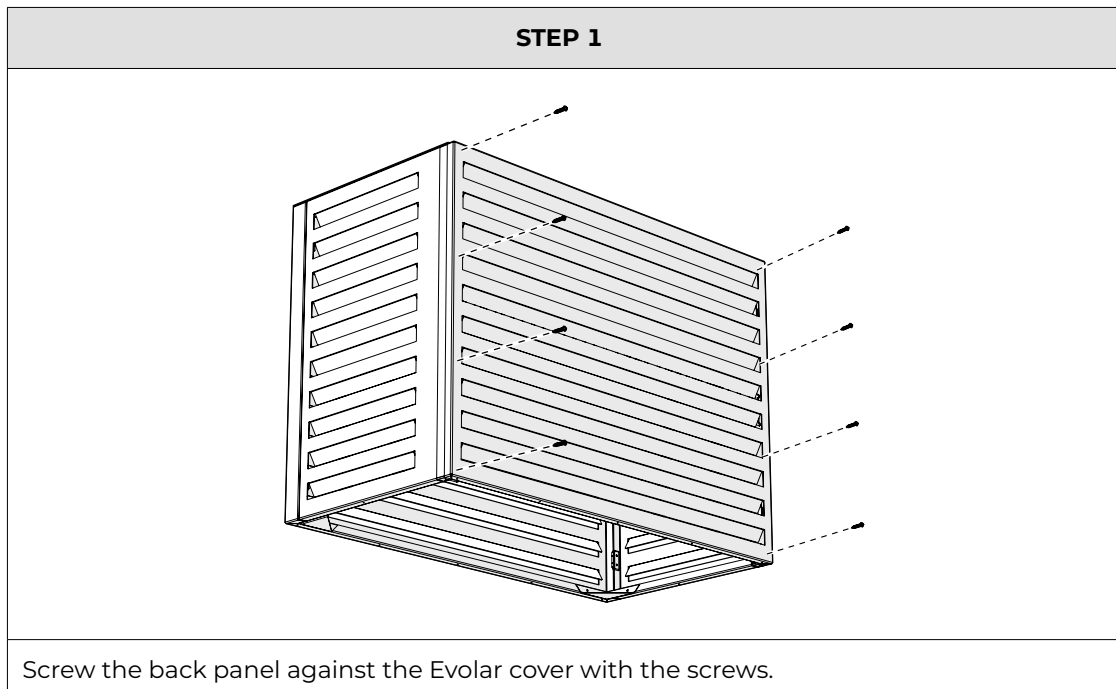

4.3 Bottom panel

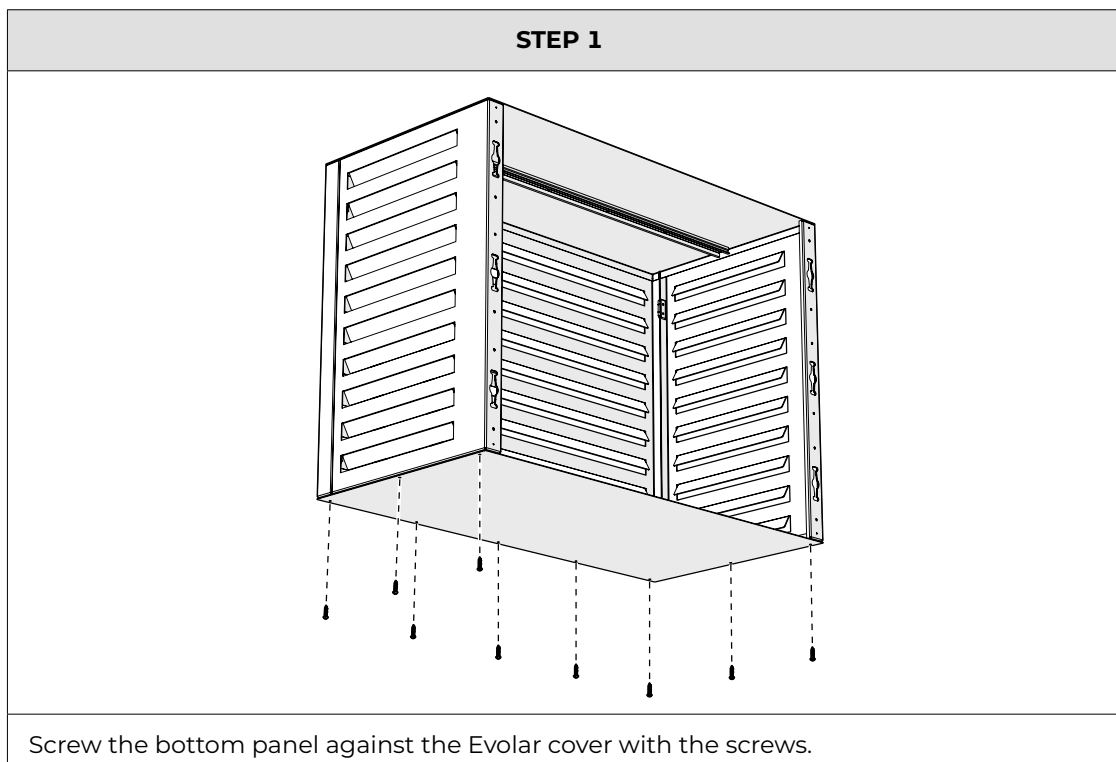

5 MAINTENANCE

NOTICE

Risk of damaging the surface of the product! Harsh chemical cleaning agents, such as ammonia, acid or acetone, can damage the product.

- Only clean the product with a soft, clean, and dry cloth.
- Avoid abrasives that could damage the surface.

6 DISPOSAL

Follow the local regulations for disposing of the Evolar cover.

7 WARRANTY

The Evolar cover has a warranty period of 24 months. This warranty is void if the Evolar cover has been used differently than indicated in this manual.

evolar

Evolar inc.

700 Milam Street, Suite 1300 - #353
Houston, Texas 77002
United States

T +31 (0)24 2120369
www.evolarshop.com

EN – Original user manual
V1.0 | 09-2023